



W
Weldons
Sales & Lettings
FOR SALE
01747 356226
www.weldonsonline.com

Imber Road, Shaftesbury

£235,000





Tenure - Freehold

Weldons Sales & Lettings are delighted to bring to the market this beautifully presented End terrace THREE-bedroom Family home located in the popular & established residential area of the Saxon Hilltop market Town of Shaftesbury, North Dorset. With ENCLOSED low maintenance rear garden. Allocated Parking. Gated Side access. Spacious sitting room. MODERN fitted kitchen/diner. Fitted Bathroom. Gas Central Heating & UPVC double glazed throughout.

Entrance Hallway

Double glazed UPVC door on entrance. Stairs to first floor. Access to Sitting room.

Sitting Room

Modern neutral decor. Fitted carpet. Under stair storage cupboard. Double glazed window with views to the front aspect. Access to the kitchen/diner.

Kitchen Diner

Modern fitted kitchen. Four ring gas Hob. Electric fan oven. Cooker hood/extractor. Space for Tall Fridge Freezer. Plumbing for washing machine. Plumbing for dishwasher. Extended breakfast bar. Gas Boiler. Space for Dining table. Patio doors leading to enclosed rear garden.

Bedroom 1

Spacious Double Bedroom with fitted wardrobe. Laid to carpet. Radiator. Various PowerPoints. Views to the rear garden.

Bedroom 2

Spacious Double Bedroom with fitted wardrobe. Laid to carpet. Radiator. Various PowerPoints. Views to the front aspect.

Bedroom 3

Single bedroom. Laid to carpet. Various PowerPoints. Radiator. Views to the rear aspect.

Bathroom

Wash Basin with built in storage. Water saving flush w/c. Bath with shower over. Extractor Fan. Ceramic tiled with vinyl flooring.

Loft

Boarded & insulated

Front Garden

Laid to Lawn, Stone Boarder with paving leading to UPVC Front Door.

Rear Garden

Enclosed low maintenance rear garden. Two Wooden Sheds. Patio wrapping around the house to side access gate. Mainly laid to lawn.

Allocated Parking

Viewing Arrangements

Viewings are strictly through Weldons Sales & Lettings by appointment only.

- Weldons Sales & Lettings - COVID 19 - Viewings guideline- Face covering/ mask is mandatory for all viewings - Please ensure you have brought one along with you.- Gloves will be issued prior any viewing - issued by Weldons Sales & Lettings- Hand sanitizer/ Hand Gel will be provided by Weldons Sales & Lettings.- Maximum 2 people per viewing.- You will not be permitted to touch anything during the viewing (regardless of gloves)- Social Distancing must be practised at all times.- If you develop any symptoms of COVID 19 you must advise us and re arrange/cancel your viewing

FLOORPLAN

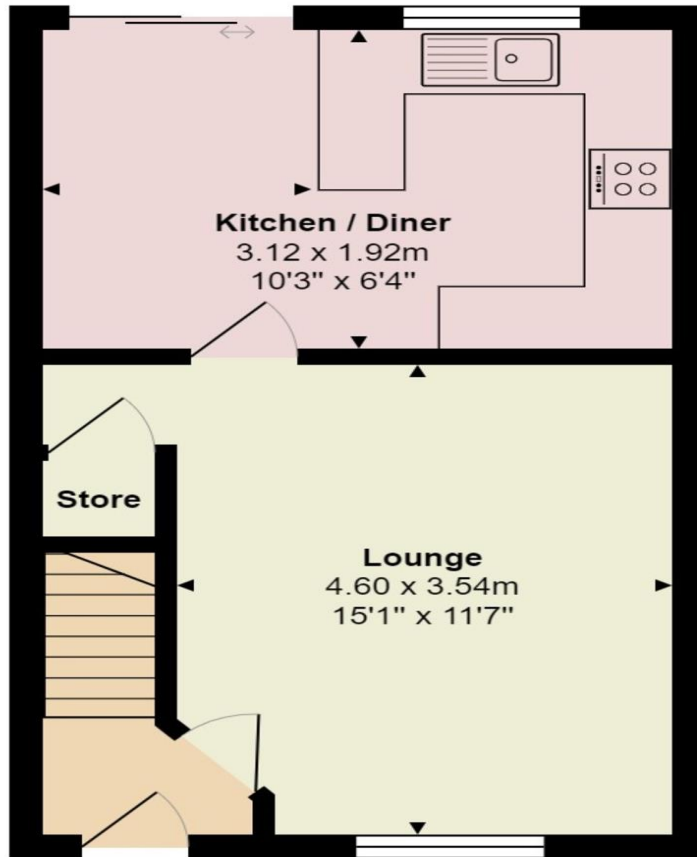

Ground Floor

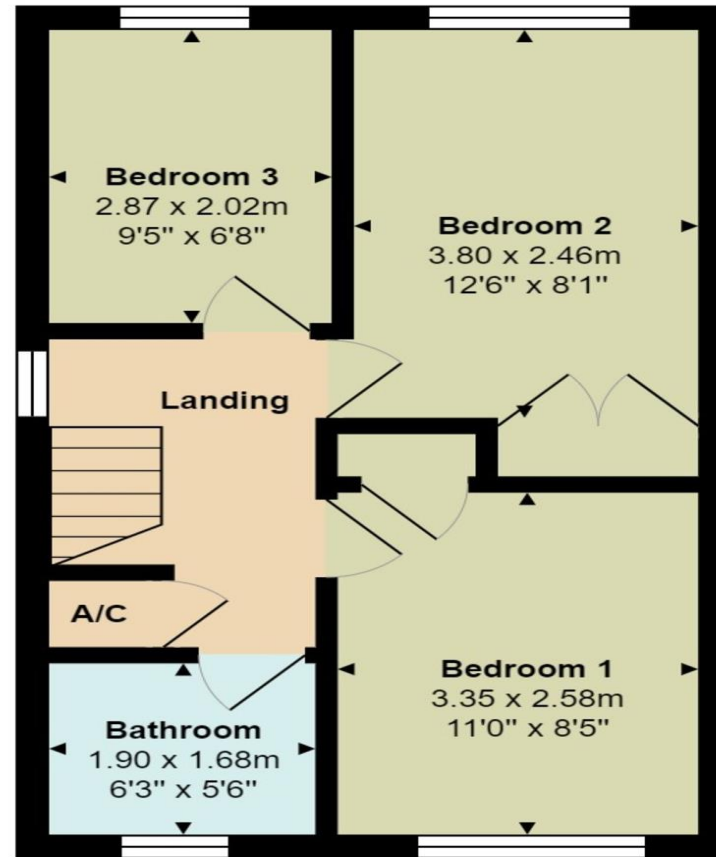

First floor